

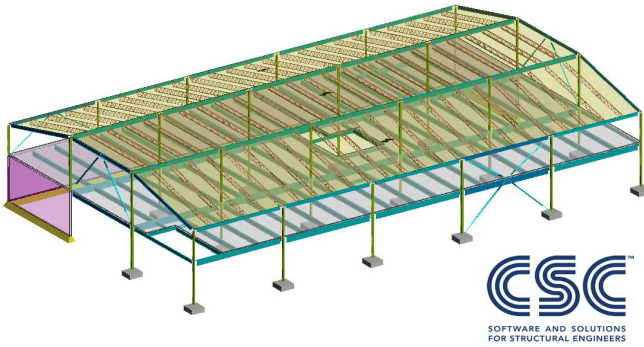

## TEDDS and Fastrak benefit Ahler & Young LLC - USA



### Ahler & Young LLC - Tennessee

Ahler & Young is a design firm that specializes in structural engineering on a wide range of projects including educational, office, institutional, municipal, commercial and industrial. The business has extensive design and construction experience to provide solutions for their clients, which are uniquely constructible and economical. Every project is managed by a senior officer within the firm, who stays with the project and client from initial marketing through design/construction phases and into post-construction follow-up. Maintaining this degree of project management is key to providing the level of service and attention to detail on which Ahler & Young is based.

The firm has used TEDDS software for the past eighteen months to save significant effort and calculation time. By working with CSC's support team, Ahler & Young were able to openly discuss, agree and implement improvements to their calculation processes using the TEDDS software.

Consequently, based on confidence in CSC's services and the return on investment achieved with TEDDS – Fastrak Building Designer was a natural investment to replace their existing steel building product. Fastrak enables bi-directional integration with Revit Structure to provide a total modeling, analysis, design and drawing production solution – for structural engineers.

"I enjoyed working directly with the 3D model in Fastrak and taking full advantage of its integration with Revit [BIM]. With the client and architect in two separate and remote locations, online meeting technology was used to clearly convey the Fastrak model – Fastrak was key to this being the best communicated project with which I have been involved."

▶ [Craig S Young, PE, SECB - Principal](#)

Visioneering Studios is a national urban planning and architectural design firm that specializes in Christ-centered communities and works exclusively in Revit Architecture. Visioneering develops distinctive buildings that help tell the Gospel story and create connections between people, cultures, community, and the Creator. It is advantageous for them to work with Ahler & Young, and other Structural Engineers, who embrace integrated work processes and use 3D modelling and design. Starting with schematics, the floor plans are established and then the verticality of the building is developed. Drawing views and section cuts are generated from the Revit model automatically so that they are always up to date with the latest project changes. Jana Edelbrock Simison, Project Architect at Visioneering Studios, was impressed by Fastrak's ability to integrate with more complex 3D geometry, particularly when comparing this to a 2 dimensional approach adopted by other Structural Engineers.

"Rather than the Contractor having to work out how various items fit together, working with the Structural Engineer in 3D helps to identify and resolve potential issues early in the design process, saving team members and the client both time and money".

▶ [Jana Edelbrock Simison - Project Architect](#)

