

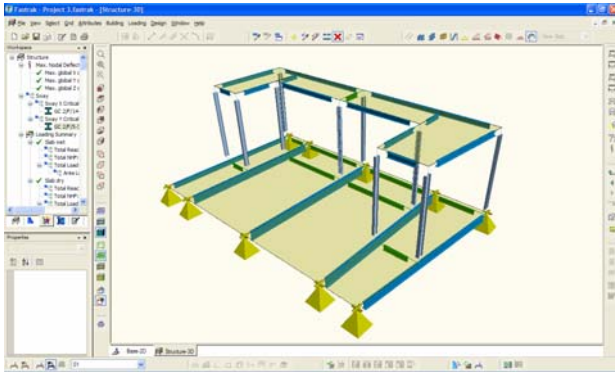

Fastrak Building Designer benefits Structural Design Services Limited



▶ Roof structure and walkway steelwork

Structural Design Services Ltd is a small structural consulting engineering practice, with three staff, based in the West Midlands. SDS services range from small scale residential housing work, to multi storey steel; portal frames and composite buildings for the commercial, retail and industrial market sectors. Being a small practice, each member of the team gets involved in a very varied work load and needs to be efficient in the design of all materials. This is made possible by using a number of computer aided design solutions provided by CSC.

TEDDS enables the day-to-day elemental calculations in all materials to be produced rapidly and documented appropriately for submission to Building Control.

Fastrak Building Designer and **Fastrak Portal Designer** are used for the focussed design of steelwork buildings.

"Fastrak Building Designer was purchased for a 5 storey composite building project which would have been very difficult to design efficiently using 'traditional methods'. The speed benefits provided by Fastrak Building Designer meant that the software paid for itself on this first project. Since then, we have used Fastrak Building Designer to model and design much smaller structures, for which we

may not necessarily have invested in software, and a design which may have taken 2 or 3 days is now completed in one. In addition, no extra time is required to prepare drawings, produce material lists and extract design data (foundation loads etc)."

▶ **Mark Goring – Principal**

Major Fastrak benefits to SDS Ltd

- ▶ Using Fastrak, steel projects can be modelled very quickly and the design produced very easily directly from the 3D model, resulting in significant time savings during design. The 3D model automatically generates general arrangement drawings, saving further time during drafting.
- ▶ The 3D model can provide many other useful reports such as material lists, beam end reactions, foundation forces, bracing forces etc - all of which may be required by various people.
- ▶ The ability to produce our small scale day-to-day designs in a fraction of the time taken previously is just as important as improving our productivity on the larger schemes..

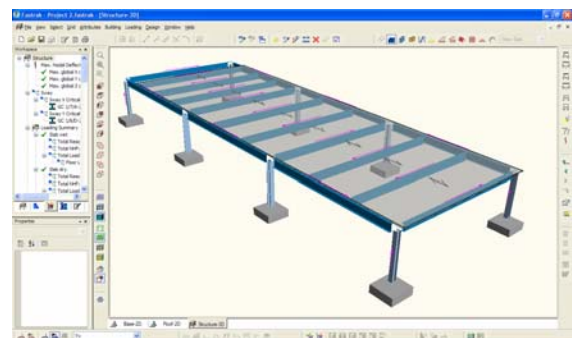

▶ Mezzanine floor